

# Grand Hyatt Denver

ADDRESS 1750 Welton St., Denver, CO 80202, USA  
PHONE 303-295-1234 SALES FAX 303-603-4074  
WEB [www.granddenver.hyatt.com](http://www.granddenver.hyatt.com)



## ACCOMMODATION

- 516 non-smoking guestrooms, including 27 suites / parlors, 253 kings, 233 double / doubles, 36 Hyatt Business Plan®, 52 Regency Club®, 17 accessible rooms, five dog friendly rooms (subject to availability), and 20 Respire by Hyatt hypo-allergenic rooms;

All accommodations offer:

- Hyatt Grand Bed™
- Flat-screen television with remote control, cable movie channels, in-room pay movies
- Voice mail, three telephones with message light, computer data port
- Video messages, video account review, video checkout
- Individual climate control
- High-speed Internet access (wired and wireless)
- Electronic door lock
- In-room safety-deposit box
- Full bath amenities
- Turndown service upon request
- Iron / ironing board
- iHome® alarm clock radio
- Hair dryer
- Coffeemaker
- Bath robes for Regency Club®

## SERVICES & FACILITIES

- Hyatt Fast Board™
- 1-800-CHECK-IN®
- 24-hour business center
- Support services
- Concierge
- Assistive devices for persons with disabilities
- Laundry and dry cleaning
- 24-hour in-room dining
- Valet parking
- Covered parking
- Multilingual staff
- Currency exchange
- Safe-deposit boxes located at front desk
- Soda, ice machines

## RESTAURANTS & BARS

- 1876—restaurant serving breakfast, lunch, and dinner
- 1876 Bar—cocktails
- Fireside Terrace Lounge—cocktails
- Starbucks®
- 24-hour in-room dining

## CONFERENCES & BANQUETS

- A total of 40,000 square feet of function space, 6,351 of prefunction space, and 8,848 square feet of exhibit space
- The 37th and 38th floor Pinnacle Club conference centers offer an additional 17,000 square feet of space
- Hyatt Conference Center, featuring large windows overlooking the Financial District
- All meeting rooms have individual or master controls for heat / air conditioning, sound, music, telephones, multiple electrical / microphone outlets, T3 capability, special lighting effects and 110V single-phase electricity
- Experts in both on and off premise-catering, with fully dedicated Kosher kitchen
- Magnificent 20 foot sandstone fireplace is the focal point of lobby
- Colorado theme carried in to hotel's 1876 Restaurant, named for the year Colorado became a state
- Spacious guestrooms, one of the largest in the region
- Ideal location, walking distance to Denver's best attractions and one block from 16th Street Mall

## RECREATIONAL FACILITIES

- Fully equipped exercise facility including free weights, exercise cycles, steppers, stair climbers, and cardio theater
- Indoor swimming pool
- Outdoor whirlpool
- Sun deck
- Spa services nearby

## POINTS OF INTEREST

- State Capitol
- Denver Mint
- Larimer Square
- 16th Street Mall
- Coors Field (Colorado Rockies)
- Colorado Convention Center
- Denver Center for the Performing Arts
- Elitch Gardens Amusement Park
- Ocean Journey
- Denver Pavilions
- Denver Art Museum
- Denver Zoo
- Molly Brown House
- Pepsi Center (Avalanche and Nuggets)
- Sports Authority Field at Mile High (Broncos)
- Paramount Theater
- Red Rocks Theater
- Fiddlers Green Amphitheater

# Grand Hyatt Denver

## ROOM DIMENSIONS & CAPACITIES

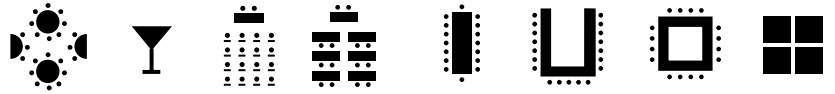

Room name

Room name	Room Dimensions Length x Width x Height	Square Feet	Banquet	Reception	Theater	Classroom	Boardroom	U-Shape	Hollow Square	Exhibit
<b>GRAND HYATT</b>										
<b>LOBBY LEVEL</b>										
MT. SOPRIS	63' x 63' x 20'	3,455	250	400	300	175	40	41	48	—
<b>SECOND FLOOR</b>										
IMPERIAL BALLROOM	112' x 80' x 18'	8,369	720	1,400	1,000	525	100	98	118	50
IMPERIAL BALLROOM FOYER	101' x 41' x 14'	3,868	252	650	—	—	—	—	106	8
GRAND BALLROOM	80' x 72' x 18'	5,906	500	800	750	400	76	84	—	36
GRAND BALLROOM FOYER	61' x 39' x 13'	2,129	144	300	—	—	—	—	—	7
BLANCA PEAK	24' x 12' x 15'	365	24	30	29	12	18	—	—	—
CRESTONE PEAK	21' x 16' x 15'	316	24	30	32	20	16	15	18	—
TORREYS PEAK	26' x 17' x 14'	456	36	50	44	27	22	24	28	—
MAROON PEAK	57' x 15' x 14'	964	72	100	104	54	48	48	52	—
<b>THIRD FLOOR</b>										
MT. HARVARD	30' x 17' x 14'	509	40	60	52	27	24	24	28	—
MT. PRINCETON	35' x 14' x 14'	633	40	70	60	36	30	30	34	—
MT. YALE	28' x 17' x 14'	482	40	50	52	27	22	23	24	—
MT. COLUMBIA	65' x 16' x 14'	1,159	100	125	132	72	58	57	60	—
MT. OXFORD	50' x 15' x 14'	914	72	100	85	51	46	45	48	—
MT. WILSON	36' x 14' x 10'	502	40	60	51	36	28	29	35	—
<b>ATRIUM TOWER</b>										
<b>CONFERENCE CENTER</b>										
GRAYS PEAK	28' x 50' x 11'	1,348	120	150	156	96	46	47	58	—
MT. EVANS	30' x 70' x 11'	1,986	160	200	219	132	60	65	70	—
MT. EVANS A	35' x 30' x 11'	986	80	100	105	54	34	35	42	—
MT. EVANS B	35' x 30' x 11'	986	80	100	105	54	34	35	42	—
PIKES PEAK	35' x 20' x 11'	638	50	100	70	30	30	26	34	—
LONGS PEAK	33' x 31' x 11'	946	70	100	105	54	34	29	34	—
MT. ELBERT	29' x 82' x 11'	2,339	200	300	265	162	72	77	88	—
<b>37TH FLOOR PINNACLE CLUB</b>										
PYRAMID PEAK BALLROOM	121' x 30' x 10'	3,580	300	450	392	246	120	110	118	—
PYRAMID PEAK A	60' x 30' x 10'	1,789	150	225	182	114	52	56	64	—
PYRAMID PEAK B	60' x 30' x 10'	1,789	150	225	182	114	52	56	64	—
SUNLIGHT PEAK	66' x 30' x 10'	2,087	180	250	217	138	58	63	72	—
CASTLE PEAK	45' x 15' x 10'	670	50	75	74	39	36	35	40	—
LA PLATA PEAK	29' x 25' x 9'11"	430	30	60	45	27	22	23	28	—
<b>38TH FLOOR PINNACLE CLUB</b>										
CAPITOL PEAK BALLROOM	120' x 31' x 15'	3,998	330	500	433	240	106	111	120	—
SAN LUIS PEAK	53' x 29' x 12'	1,434	100	150	140	84	46	47	52	—
CRYSTAL PEAK	53' x 19' x 9'	1,837	60	150	64	30	34	35	40	—
LIBRARY	20' x 22' x 9'	719	60	75	84	48	28	26	30	—

All meeting rooms are equipped with black-out drapes. Audio/visual, sound and telephone capabilities are also available. (Some fees do apply)



## Grand Hyatt Denver

### DIRECTIONS

From Denver International Airport (40 minutes): Exit Pena Blvd. to I-70 West. Proceed to I-25 South. Exit at Speer Blvd. South (exit 212A) and proceed on Speer Blvd. Turn left on Lawrence St. Turn right on 17th St. Turn left on Welton.

### SECOND FLOOR BALLROOM

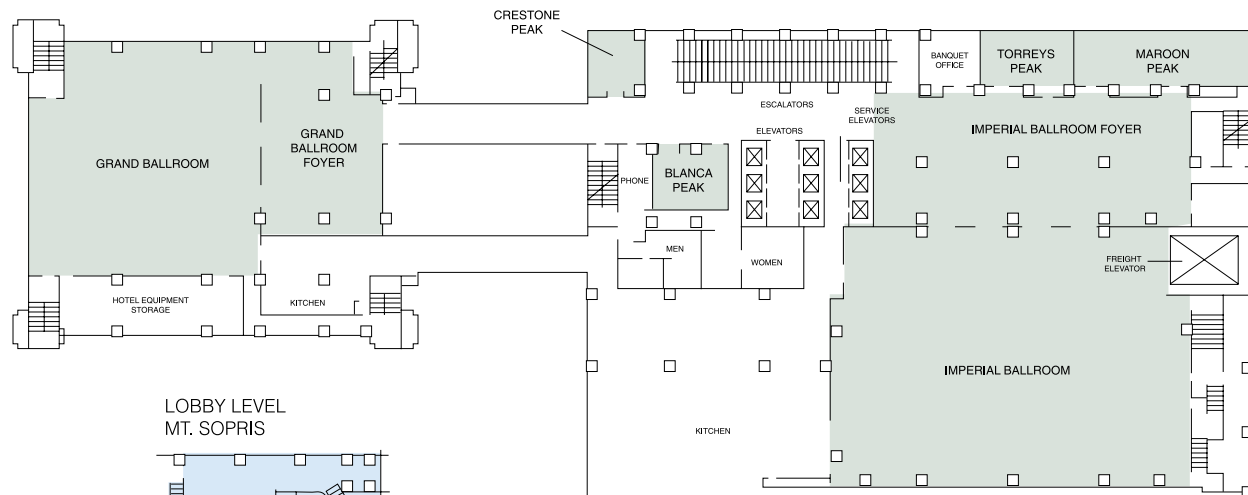

### LOBBY LEVEL MT. SOPRIS

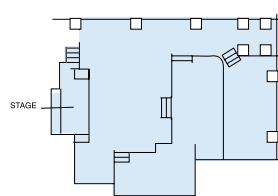

### THIRD FLOOR MEETING ROOMS

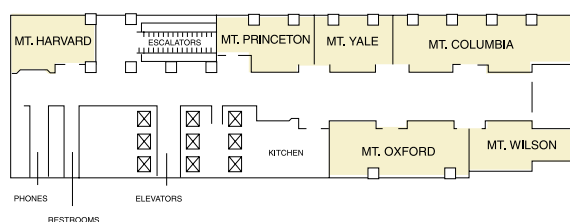

### HYATT CONFERENCE CENTER

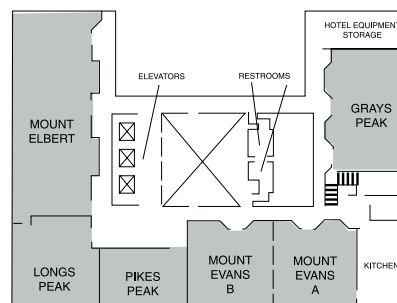

# Grand Hyatt Denver

## PINNACLE CLUB

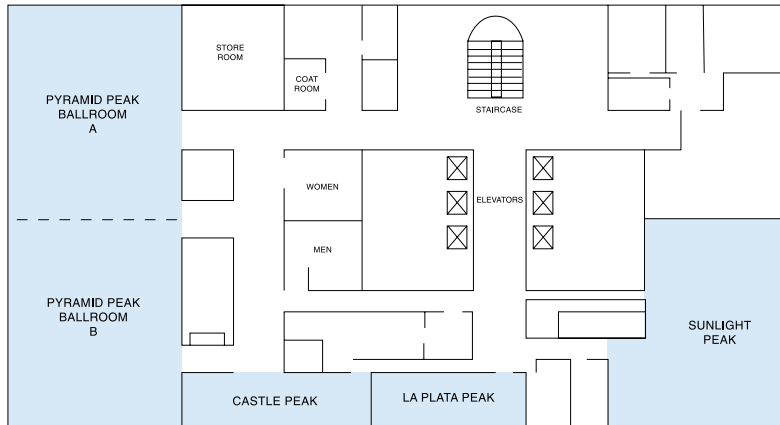

PINNACLE CLUB 37TH FLOOR

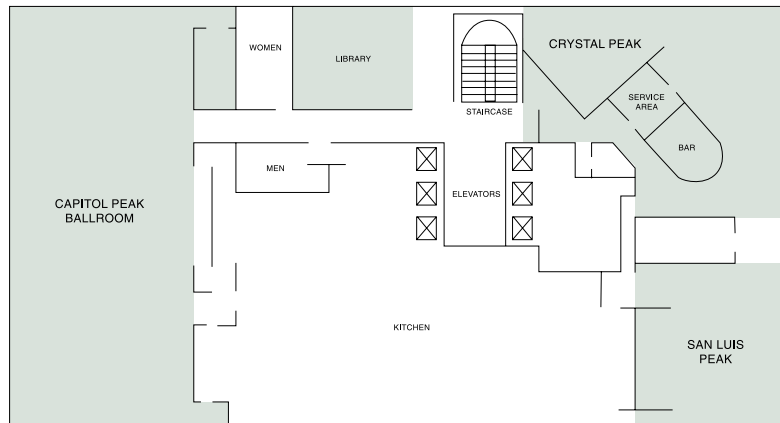

PINNACLE CLUB 38TH FLOOR